

DO NOT SCALE

LEGEND

Site Boundary

Existing Vegetation

- Existing tree to be retained
- Existing Hedgerow Retained
- Existing Grass Verges Retained
- Existing Mixed Vegetation To Be Cleared.

Existing Street Furniture

- Existing Street Furniture to be retained where possible
- Existing Bench
- Existing Litter Bin
- Existing Cycle Stands
- Existing Utilities
- Missing Utilities From Topo
- Affected services to be lifted to meet new levels

Existing Kerbs

- Existing Kerb
- Existing Road Markings Retained

Proposed Soft Landscape

- Wildflower Turf

Proposed Street Furniture

- Timber and Steel Bench with arm and back rests
- Information Board
- Modular Timber and Steel Bench with arm and back rests
- Dual Waste and Recycling Bin
- Proposed Removable Bollards
- Cycle Stands
- Cargo Bike Stands
- Proposed drainage channels to connect outlet with carriageway
- Proposed relocated wayfinding by others

Proposed Hard Landscape

- Flag Paving
- Flag Paving - Feature
- Block Paving
- Asphalt - to match existing
- Buff Tactile Paving (Uncontrolled Crossing)
- Raised table with coloured asphalt

Proposed Kerbs

- Proposed Flush Kerb
- Proposed Kerb
- Proposed Road Markings
- Proposed Road Markings

FOR INFORMATION ONLY

REV	DATE	BY	DESCRIPTION	CHK	APP
P02	13/04/2026	KK/NC	Second issue		
P01	19/12/2025	NC/KK	First issue	JF	PT

DRAWING STATUS: **S2 - FOR INFORMATION**

WSP House, 70 Chancery Lane, London, WC2A 1AF, UK
 T+ 44 (0) 207 314 5000, F+ 44 (0) 207 314 5111
 wsp.com

CLIENT: **Greater Cambridge Partnership**

SITE/PROJECT: **Bottisham Greenway - Riverside Vision**

TITLE: **Riverside General Arrangement Plan
Sheet 2 of 3**

SCALE @ A1: 1:200	CHECKED: JF	APPROVED: PT
PROJECT NO: UK0030709_0245	DESIGNED: KK/NC	DATE: April 26
DRAWING NO: 30709-WSP-ZZ-XX-DR-LA-3202	REV: P02	

© WSP UK Ltd

File name: C:\Users\uk0030709_0245\OneDrive - WSP\Documents\30709_0245\WSP-XX-DR-LA-3202_LANDSCAPE LAYOUTS - OPTN 2 - UPDATE.DWG, printed on 13 April 2026 11:34:18, by Kamalada, Kishan
 This drawing may contain: Ordnance Survey data © Crown copyright and database right 2026.

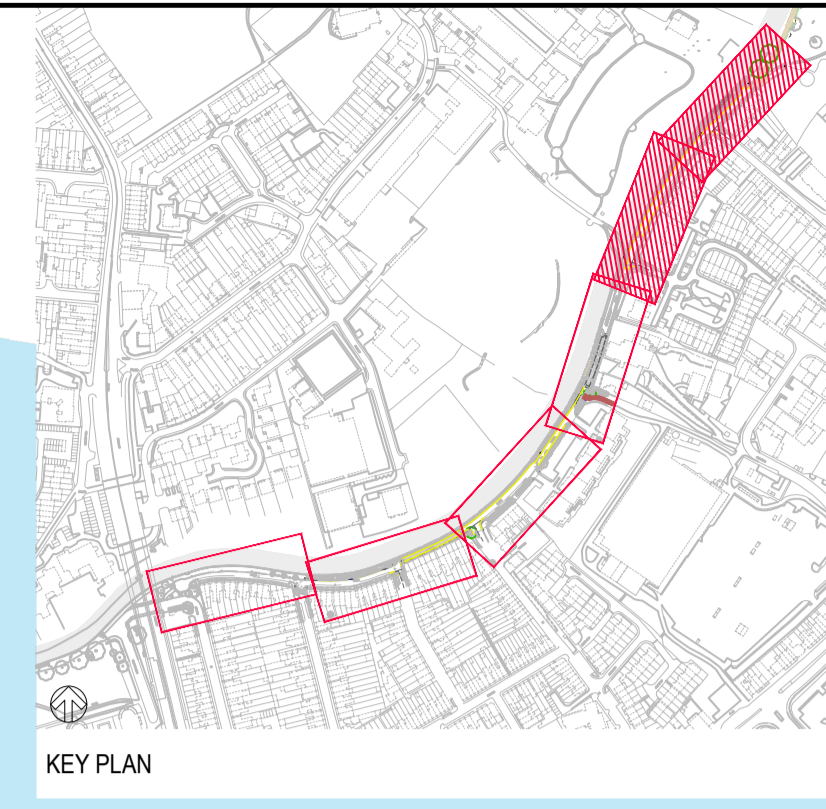
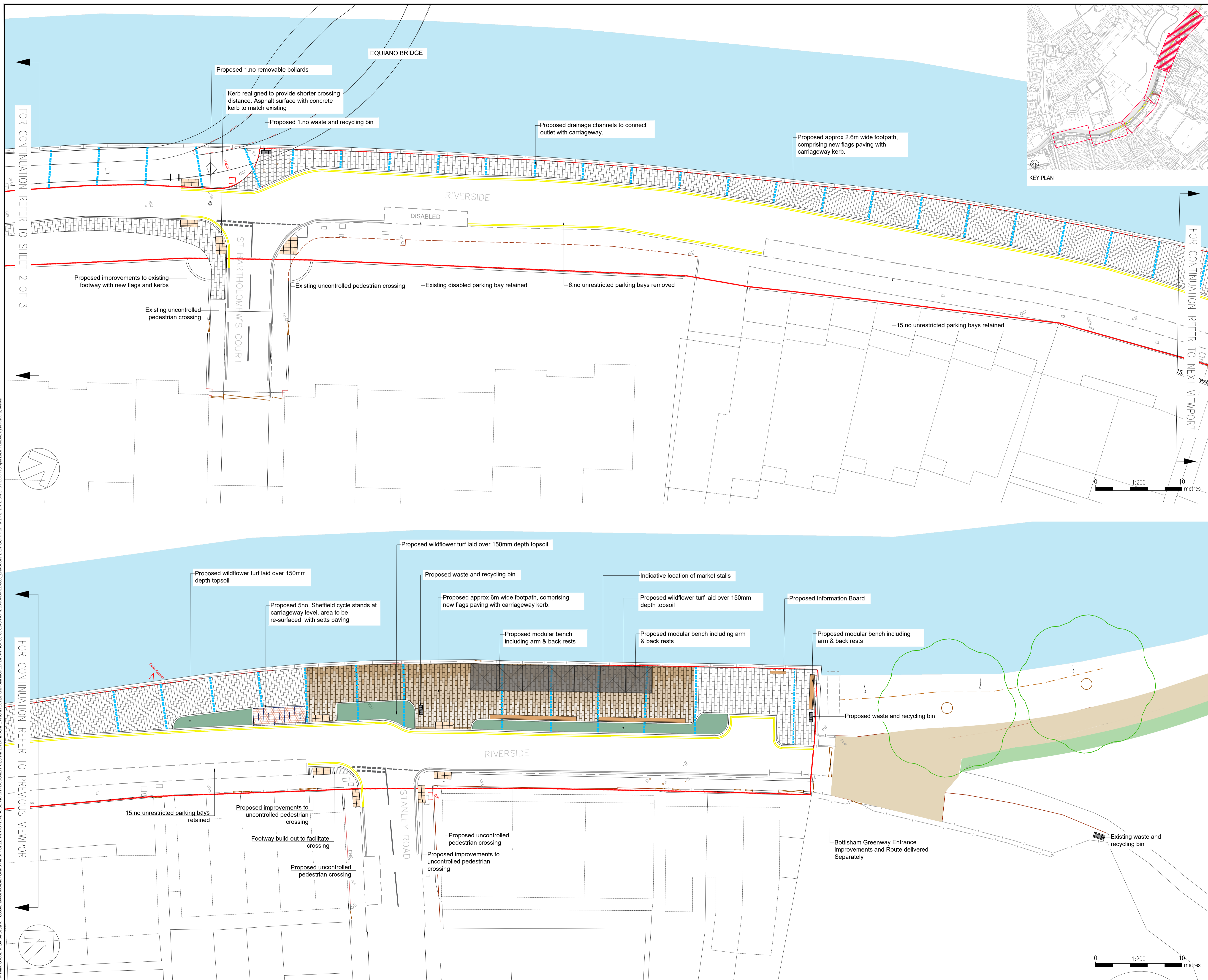

DO NOT SCALE

LEGEND

- Site Boundary
- Existing Vegetation**
 - Existing tree to be retained
 - Existing Hedgerow Retained
 - Existing Grass Verge Retained
 - Existing Mixed Vegetation To Be Cleared
- Existing Street Furniture** (Existing Street Furniture to be retained where possible)
 - Existing Bench
 - Existing Litter Bin
 - Existing Cycle Stands
 - Existing Utilities
 - Missing Utilities From Topo
 - Affected services to be lifted to meet new levels
- Existing Kerbs**
 - Existing Kerb
 - Existing Road Markings Retained
- Proposed Soft Landscape**
 - Wildflower Turf
- Proposed Street Furniture** (Existing Street Furniture to be retained where possible)
 - Timber and Steel Bench with arm and back rests
 - Information Board
 - Modular Timber and Steel Bench with arm and back rests
 - Dual Waste and Recycling Bin
 - Proposed Removable Bollards
 - Cycle Stands
 - Cargo Bike Stands
 - Proposed drainage channels to connect outlet with carriageway
 - Proposed relocated wayfinding by others
- Proposed Hard Landscape**
 - Flag Paving
 - Flag Paving - Feature
 - Block Paving
 - Asphalt - to match existing
 - Buff Tactile Paving (Uncontrolled Crossing)
 - Raised table with coloured asphalt
- Proposed Kerbs**
 - Proposed Flush Kerb
 - Proposed Kerb
 - Proposed Road Markings
 - Proposed Road Markings

FOR INFORMATION ONLY

REV	DATE	BY	DESCRIPTION	CHK	APP
P02	13/04/2026	KK/NC	Second issue		
P01	19/12/2025	NC/KK	First issue	JF	PT

DRAWING STATUS: **S2 - FOR INFORMATION**

WSP House, 70 Chancery Lane, London, WC2A 1AF, UK
T+ 44 (0) 207 314 5000, F+ 44 (0) 207 314 5111
wsp.com

CLIENT: **Greater Cambridge Partnership**

SITE/PROJECT: **Bottisham Greenway - Riverside Vision**

TITLE: **Riverside General Arrangement Plan
Sheet 3 of 3**

SCALE @ AT:	CHECKED:	APPROVED:	
1:200	JF	PT	
PROJECT NO:	DESIGNED:	DRAWN:	DATE:
UK0030709.0245	KK/NC	KS	April 26
DRAWING No:	30709-WSP-ZZ-XX-DR-LA-3203		REV: P02

© WSP UK Ltd

File name: C:\Users\mk002020\OneDrive\Work\Projects\30709\0245\WSP\Drawings\0245\WSP-ELS-X-DR-LA-0001_LANDSCAPE_LAYOUTS - UPTN 2 - UPDATE.DWG, printed on 13 April 2026 11:35:00, by Kamanda, Keenan
 This drawing may contain: Ordnance Survey data © Crown copyright and database right 2026

- NOTES:**
- DO NOT SCALE FROM THIS DRAWING.
 - SITE VERIFY ALL DIMENSIONS PRIOR TO CONSTRUCTION.
 - REPORT ALL DISCREPANCIES TO THE DRAWING ORIGINATOR IMMEDIATELY.
 - THIS DRAWING IS TO BE READ IN CONJUNCTION WITH ALL RELEVANT DOCUMENTS AND DESIGN DRAWINGS.

- KEY:**
- PROPOSED/EXISTING FOOTWAY
 - PROPOSED CYCLEWAY (RED COLOURED SURFACING)
 - PROPOSED RED COLOURED TACTILE PAVING
 - PROPOSED CYCLE SYMBOL TO TSRGD DIAG NO. 1057
 - PROPOSED / EXISTING VERGE
 - PROPOSED SIGN
 - PROPOSED STREET LIGHTING COLUMN. EXISTING STREET LIGHTING COLUMN TO BE REMOVED AND NEW ONE TO BE INSTALLED TO THE BACK OF PAVEMENT.
 - PROPOSED CYCLE ROUTE MARKING BOLLARD (GLASDON ENSIGN OR EQUIVALENT)
 - PROPOSED KERBING
 - PROPOSED WHITE ROAD MARKINGS
 - EXISTING TREE TO REMAIN
 - TYPICAL CROSS SECTION LOCATION

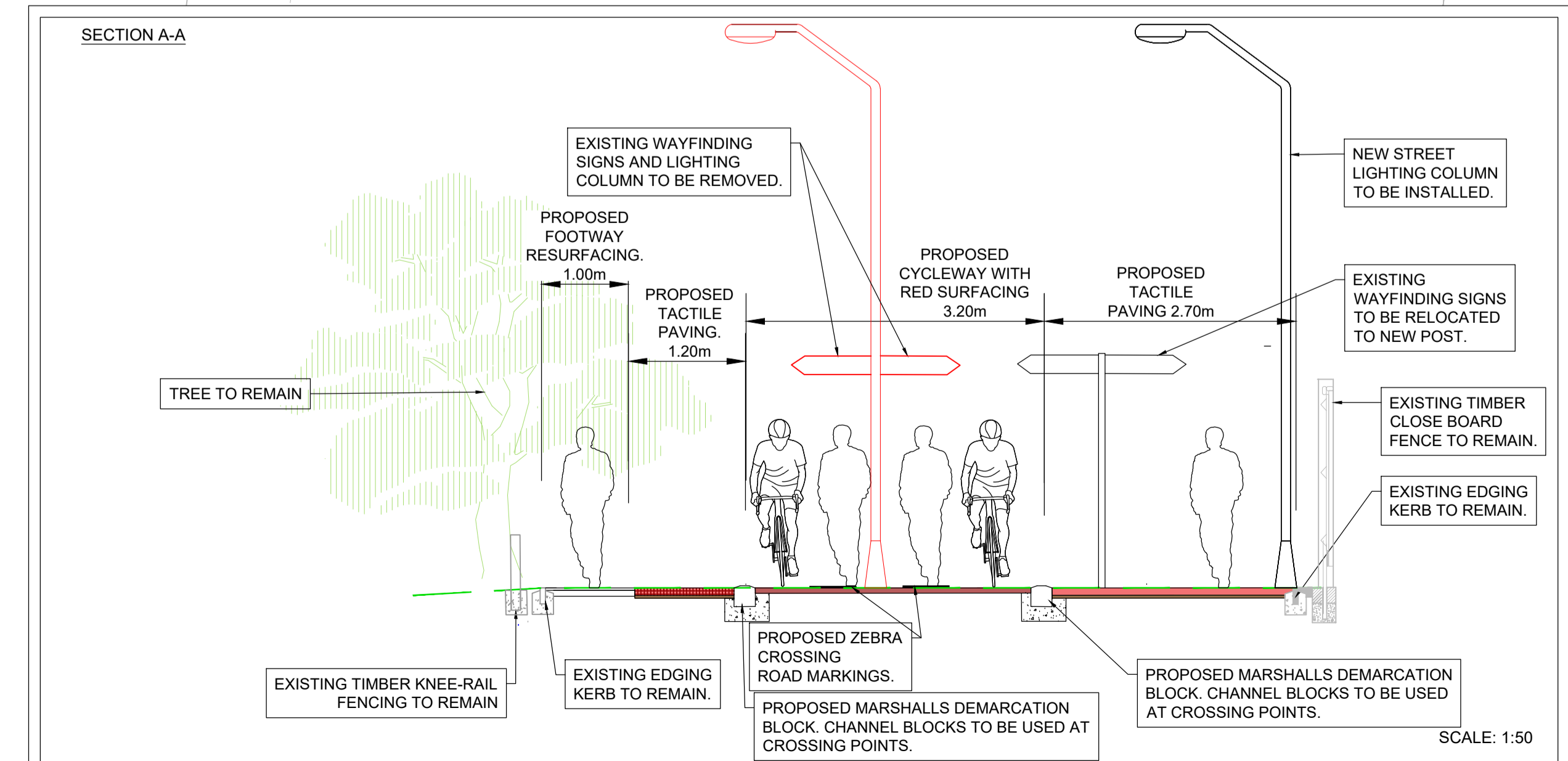
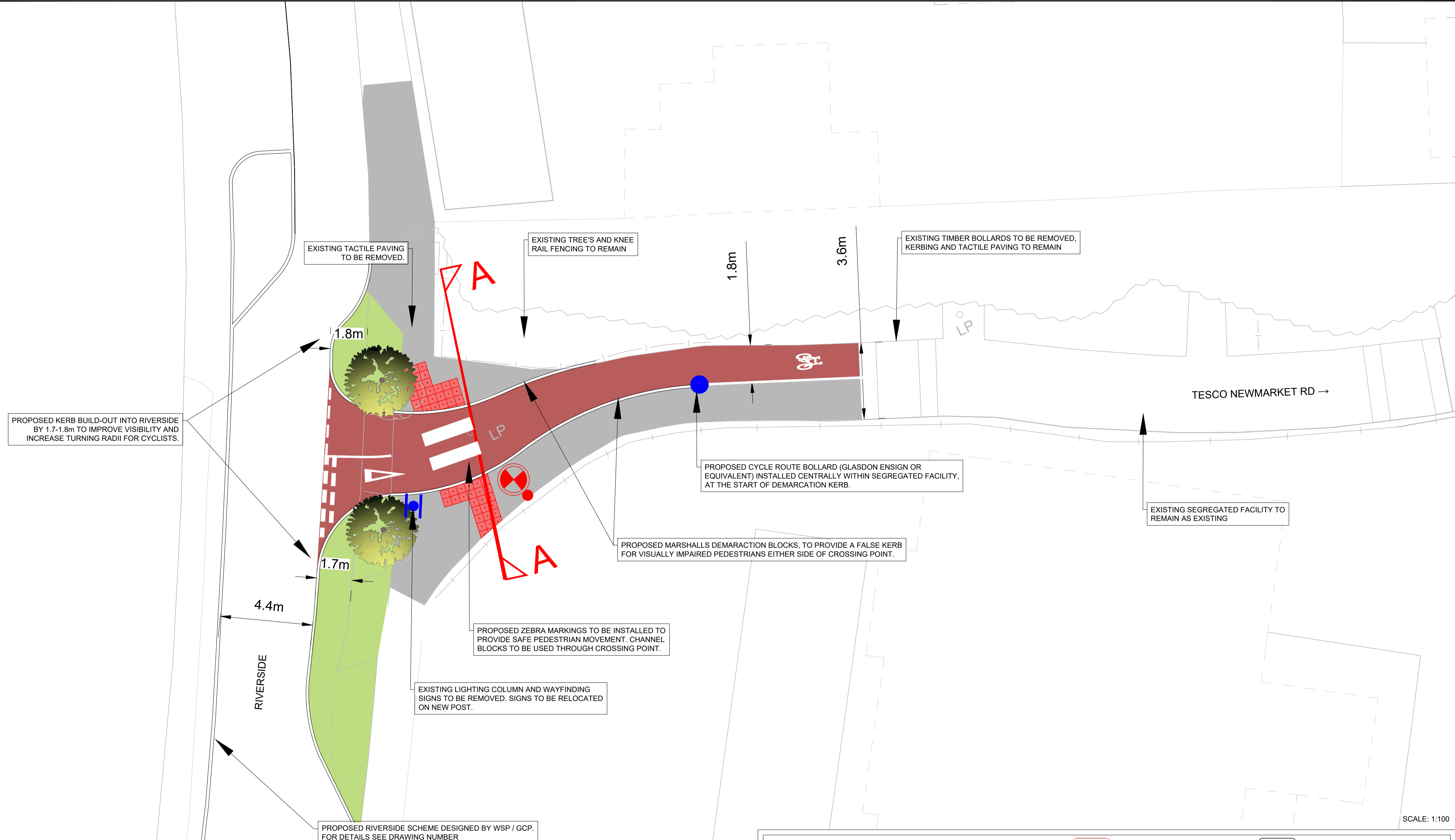

P01	FIRST ISSUE	TC			
Rev	Date	Description	Drn	Chkd	App
Revisions					

Client
Cambridgeshire Highways
 working for Cambridgeshire County Council

Drawing Originator
 Vantage House, Vantage Park, Washingley Road, Huntingdon, PE29 6SR.

M GROUP
 Woodlands Court, Burnham Road, Beaconsfield, Buckinghamshire, HP9 2SF
 This drawing is copyright of M GROUP and shall not be reproduced without prior written permission.

Drawing Status
FOR INFORMATION
 Project Name
DTSA - RIVERSIDE TO NEWMARKET RD

Title
GENERAL ARRANGEMENT

DRAFT

Sheet Size A1	Scale AS SHOWN	Drawn by TC	Checked by	Approved by
		Drawn Date 18/05/2026	Checked Date	Approved Date

Drawing Number 5020828-MH-HGN-DR-CH-0104	Status S2	Rev P01
--	---------------------	-------------------